



# **1983 MAICO SPECIFICATIONS**





**BRACE YOURSELF!** 1983 is the year of the big change for Maico racing machines. Maico – after nearly two years of intensive research – has come up with a tremendously advanced pair of motocrossers.

Realizing the demand for lighter and faster machines, Maico completely re-tooled for the new "Spider" series bikes. This step was not taken lightly and a great deal of thought, engineering innovation and commitment was involved.

The goal was basic: build a genuine works bike and make it available to the public. While it's easy to state a goal, it's a lot harder to get there. To get substantial weight reductions and "factory" type horsepower, the Maico engineering had to literally start with a clean sheet of paper on the drawing board.

New concepts in frame design were achieved, weight was pared off at every point possible without sacrificing strength and the ultimate in state-of-the-art suspension was developed.

After initial development, our International Racing Team assisted in testing and further refinements. When they were satisfied, the bikes were put through the rigors of Grand Prix racing ... with excellent results. Hans Maisch, Walter Gruhler, Mauricio Dolce and Benny Wilken all performed well in the brutal world of European Grand Prix racing.

Long time Maico riders will notice a departure in frame design. A new single down-tube splits into a full cradle, lending incredible rigidity where the engine is mounted to the frame tubes. The heavily stressed regions of the frame are reinforced with ultra-light weight massive gussets. Careful attention was given to advanced angularity for maximum strength. In a word, there are no weak points in the new Spider Type 361 chassis.

A glance at the swing arm shows that it's slimmer and much lighter than last year's box design. Lab testing shows that the new arm (only a little bit heavier than an aluminum arm!) is actually stronger than the old one. Strength was gained by using advanced "bridge sectioning" gusset techniques. This also lends a great deal of lateral strength to the swingarm that did not exist in previous designs.

All things considered, even though the new chassis is lighter, it's worlds stronger. Quite a step forward and one that any racer will appreciate on the track.

Maico engineers completely reworked the rear suspension, with both mechanical improvements and altering the rising rate. A new twin rocker system yields a soft initial ride, but helps resist bottoming out over really bad bumps.

To assist the new design, an Ohlins gas pressurized shock comes as standard equipment on the Spiders. This world class suspension unit has complete adjustability for damping changes, without going inside the shock itself, quite an aid for ever-changing track conditions and rider preference levels.

Heim joints are fitted to the suspension system and grease flow passages are standard equipment, for less maintenance and easier servicing. Less time in the shop means more time on the track.

Up front, the sturdy 42 mm Maico fork tubes have been refined. Adjustability is first rate, with air valve fork caps and a variety of oil levels and types to choose from, depending on track demands and rider needs. A new progressive wound spring gives the rider a soft and plush initial stroke, then firms up properly for the serious bumps.

Both new Spider engines – the 250 and the 490 – are very light and compact. Much weight has been removed compared to the old design. Larger fins can be found on the 250, to allow greater cooling and the use of much more "radical" porting designs.

The new 250 is quick! The power delivery hits harder and the lighter piston lets the revs build **RIGHT NOW!**

A full reed setup is now on the new 490 barrel. This gives even more low end to the already legendary Maico power characteristics. Because of the tremendous increase in low rpm power, four speeds are all the serious racer will need. Our GP racers report that even with the four speed gearbox, first gear is never needed on the tightest turns.

Both engines have the new primary gear drive, replacing the chain system. Housed in the completely new cases, is a new clutch design with a super light clutch pull. Lighter cranks let revs build quicker...and save weight.

A built in safety factor – a rubber cushioned clutch housing on the big bike – helps smooth out some of the awesome power delivery to the balance of the drive train.

Throughout both engines, you'll find stronger and larger bearings, simplified and strengthened parts and a cleanliness of design that shows painstaking work and advanced engineering techniques. Just about the only things a Maico rider will recognize on the new engine are the shift lever and the drain plug!

Maico has not stopped at internal changes alone; the new bikes have a modern, crisp look and a "Spidery" light stance. A red safety seat tops off the brilliant overall red color scheme. **THIS NEW BIKE TRULY STANDS OUT FROM EVERYTHING ELSE AVAILABLE.**

Square side panels are trimmer and fresh plastic can be found everywhere. A new one-piece air box fits cleanly in the frame.

Other details include a lightweight plastic chain guide (one piece!) and a streamlined straight pull rear brake that's half the weight of the 1982 stopper. New Nordisk wheels at both ends are stronger.

With all of the improvements and changes, Maico has still managed to meet their number one goal for 1983: to make the lightest, most effective racing bikes possible.

With a dry weight of 218 pounds for the 250 and 227 for the 490, they are right on target. More power...better power...less weight...better suspension...it's all here, in the new Spider 250 and Spider 490.

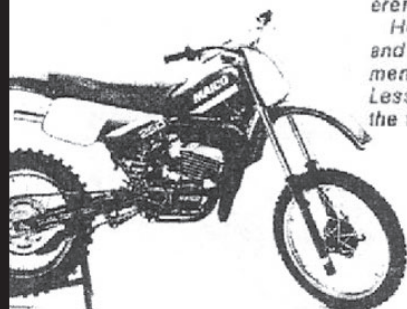



In 1982, Maico doubled the sales of their enduro line. The reason was simple; for the first time ever, the bikes came equipped for the particular demands of the American market.

A big 3.5 gallon gas tank, skid plate, wide ratio box and lightning quick turning abilities all made Big Red a force to be reckoned with on the enduro circuit.

For 1983, Maico made a good thing even better.

The 490 Spider "E" enduro model now has a reed-valved engine. This will let the big Open Class weapon pull like a tractor from idle all the way to the peak revs.

Maico engineers also found that the reeded engine gives a stunning increase in mileage, something that every serious rider finds important. This means that you can get STAGGERING range out of the 3.5 gallon standard tank, without worrying about pit stops.

The legendary double down tube chrome moly Maico frame is standard on the Spider "E".

With unmatched rigidity as its trademark, the full cradle chassis is a perfect compliment to the suspension and engine. Straight-line stability and razor-sharp handling are built-in. Or, as we like to say it, "hand built-in," at the factory.

A sturdy (and very light!) skid plate attaches to the bottom frame rails for rocky runs. For mud races, it can be quickly detached, if the rider so desires.

Positive VOR-GAS-BATTLES-UP-1-14  
"BATTLES UP"

For '83, the Maico is equipping the Spider "E" with the ultimate bump-eater available: the Ohlins gas shock. This expensive and sophisticated unit has proven itself in the suspension race like no other unit on the market. Maico is proud to offer the best...as standard equipment. Of course, the Ohlins are fully adjustable on compression and rebound.

Up front, the famed 42 mm forks have the very latest progressive wound springs and "works" damper rods; the same equipment used by our International MX Team. Running lower air pressures enables the rider to have a wide range of tuning capabilities. The action and ride control is second to none.

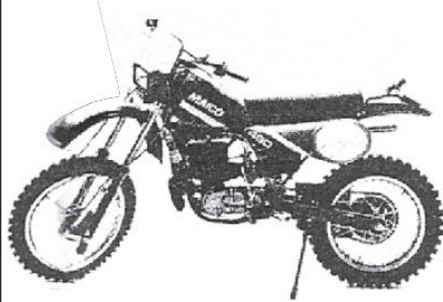

Anyone can make horsepower. All you need is a porting tool and access to a dyno. But...the RIGHT kind of power is quite a bit harder to come by. Here's where Maico leads the pack.

You've heard the phrase "European" power? Our Oriental competitors have searched for this secret for years...to no avail. It's not a secret at Maico. We've just mastered the careful and precise combination of flywheel weight, porting specs, pipe science, inlet technology, cylinder scavenging, carburetion and ignition that lets the rider control the motor. Rather than have the motor control the rider.

This "power" is much more than pure horsepower. It's correct horsepower. The kind of controlled punch that lets you glide through slippery woods, torque over sharp rocks, blast up tractionless hills and hit warp speeds on the fast fireroads, with complete confidence.

European power, indeed. Would you expect anything less? After all, we invented it.

A multitude of small changes to an already sound design are sensible. The name of the game in enduro, is FINISH.

The Spider "E" machines are equipped with Motoplat ignitions and lighting coils this year. The Motoplat has an unexcelled record.

The rear brake assembly design is made for quicker and easier rear wheel removal.

An aluminum silencer/spark arrester is stock. It's feather light and U.S. Forestry approved. It can also be rebuilt in minutes and cuts exhaust noise to a whisper.

New colorful graphics let the Spider "E" stand out from the older models and lend the bike a fresh look.

Enduro riding demands a lot from a rider. It's only fair, then, that the enduro rider demand a lot from his bike. The Spider "E" is just what the deadly serious competitor needs: A VERY SERIOUS, VERY SOPHISTICATED, HIGHLY ADVANCED PIECE OF RACING MACHINERY.

It's designed to conquer terrain.  
Quickly.  
Quietly.  
Efficiently.

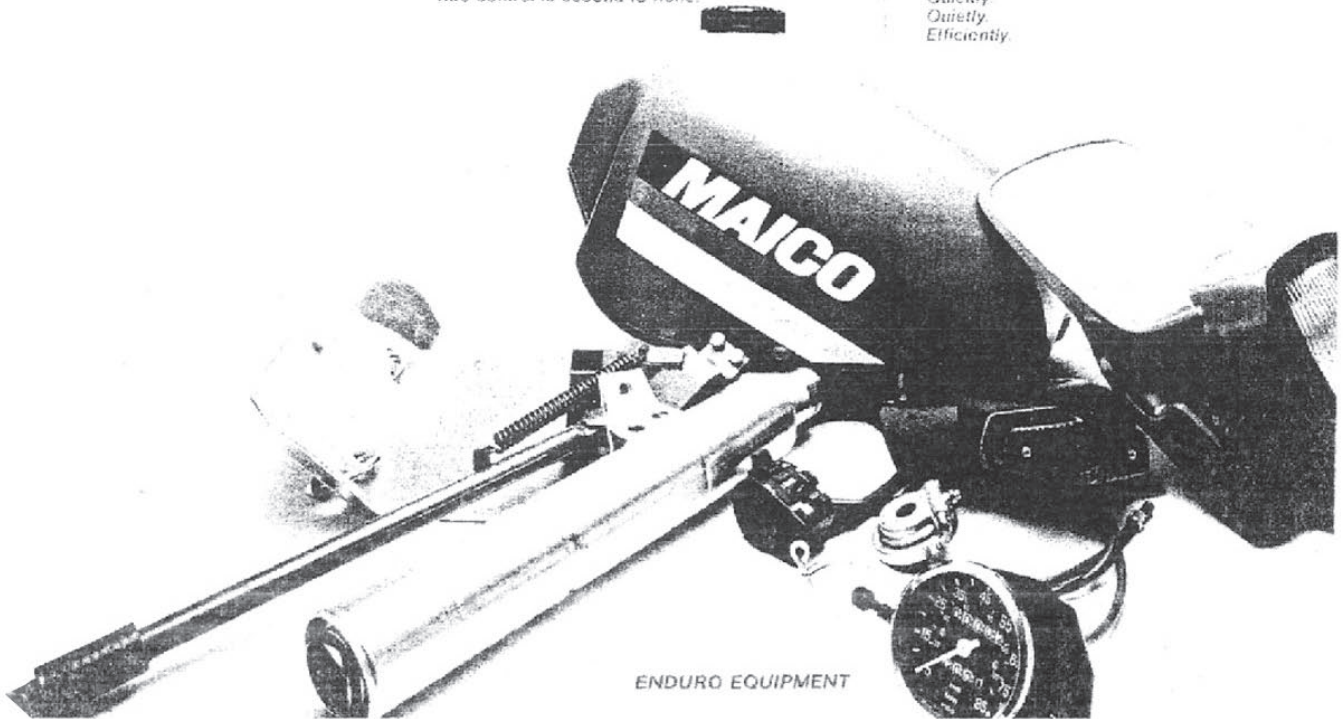

ENDURO EQUIPMENT



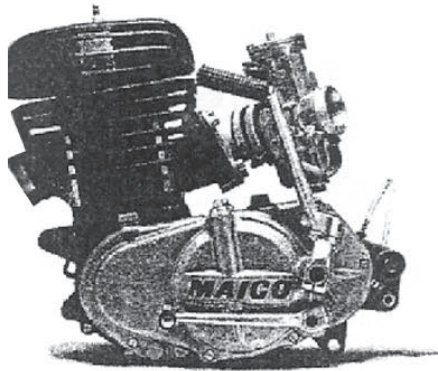

TECHNICAL INFORMATION: ENDURO SERIES 1983 - SPIDER E

**250 Spider E**

Chassis Type 354  
Engine Type 253

**490 Spider E**

Chassis Type 354  
Engine Type 254

Max. length	2190mm(86.22")	
Max. height	1290mm(50.78")	
Max. width	850mm(33.5")	
Wheel base	1510mm(59.45")	
Seat height	960mm(37.8")	
Ground clearance	372mm(14.64")	
Dry weight	107kg (238 lbs)	109kg (240 lbs)
Intake system	Reed valve intake	Reed valve intake
Exhaust system	Air cooled two stroke with loop scavenging.	Air cooled two stroke with loop scavenging.
Bore & stroke	67 x 70mm	86.5 x 83mm
Displacement	247ccm	488ccm
Compression ratio	12:1	12:1
Carburetor	Bing type V54/2.1 Ø38mm	Bing V54/2.2 Ø40mm
Horse power (DIN)	29.4kw (40 hp) @8000 RPM	39kw (53 hp) @7000 RPM
Fuel	High octane, (92+), oil mix 20:1 Bel-Ray MC3, 40:1-50:1 Bel-Ray MC1 + or 2 stroke oil with recommended mix.	
Intake system	Large volume foam filter in large air box	
Exhaust system	High pipe with removable high performance aluminum spark arrestor/muffler.	
Ignition	Pointless Thyristor Motoplatt with lighting coil	
Ignition timing (BTDC)	1.6 ± 0.1mm	2.1 ± 0.1mm
Spark plug	Champion M2 or M84G, NGK B9ES	
Clutch	Multiplate, oil bath clutch with 6 (steel) and 6 (steel) plates.	
Primary ratio	41/18 = 2.28	39/21 = 1.86
Final drive ratio	52/14 = 3.71	52/14 = 3.71
	Optional sprockets 12T, 13T, 15T, optional gear wheel sprocket 54T/56T.	
	Dog shifting, 5 speed gear box with mainshaft, layshaft and drive countershaft. With 3 shift forks, shifting plate operated through shifting cam with engaged hooked ratchet, left foot operated.	
Gear Ratios	250 Spider E	490 Spider E
Type of Gear	GT1	GT1
	Internal (Overall)	
1st Gear	2.98(25.2)	2.98(20.6)
2nd Gear	2.17(18.36)	2.17(14.9)
3rd Gear	1.65(13.95)	1.65(11.4)
4th Gear	1.25(10.6)	1.25(8.6)
5th Gear	1.00(8.45)	1.00(4.9)
Gear lube	SAE 20W-50 motor oil-800 cc	
Primary chain	52 links, 2 single row individual chains.	
Drive chain	3/8 x 7/32 5/8 x 1/4" 112 links	5/8 x 1/4" 112 links
Front wheel travel	310mm (12.2")	
Spring, damping	Double loop chrome - moly tubing. Center shock frame. Hydraulic telescopic forks with Ø42mm fork tubes. Aluminum fork sliders, progressive operating dampers, progressive wound spring, compressed air.	
Oil capacity	Progressive wound spring - additional air pressurized (10-14 psi). Hydraulic damper with rebound spring.	
Steering head	Approximately 635cc hydraulic oil per leg. HL25 or AFT (SAE 10) Bel-Ray LT100 or LT200. Oil level measures 16cm from the top of the fork tube.	
Rear suspension	Covered tapered roller bearings. Play free. Adjust without tension.	
Rear wheel travel	Swingarm mounted with needle bearings and sealed by O-rings. Pressurized reservoir Ohlins gas shocks with floating piston in reservoir. Length 474mm (18.66") Ohlins gas center shock with adjustable rebound damping.	
Front brake	325mm - (12.8")	
Rear brake	Drum brake - 136 Ømm. Brake shoes 25mm wide. Operated by right hand.	
Front tire	Drum brake - 160 Ømm. Brake shoes 30mm wide. Operated by right foot.	
Rear tire	3.00 x 21	
Tank	4.50 x 18	
Color	Centrifugal molding plastic tank 13.25 lit. (3.5 gal)	
Headlight	Spider red (frame, tank, fender, side panels).	
Brake light	35 watt/12 volt	
Tail light	24W/12V 6W/1V	

Technical specifications are subject to change without notice.





TECHNICAL INFORMATION: MOTOCROSS SERIES 1983 - SPIDER

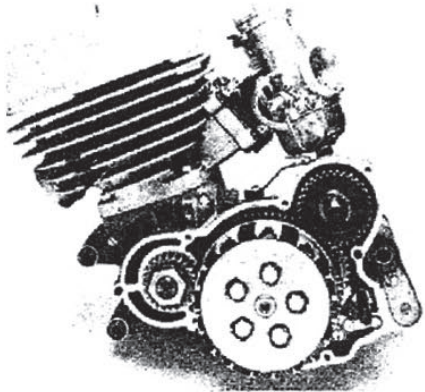

	Chassis Type 361 Engine Type 361	Chassis Type 361 Engine Type 362
Max. length	2175mm(85.62")/2210mm(87")	
Max. height	1250mm(49.21")	
Max. width	850mm(33.5")	
Wheel base	1490mm(58.66")/1530mm(60.23")	
Seat height	1020mm(40.15")	
Ground clearance	372mm(14.64")	
Dry weight	99kg(218 lbs)	103kg(227 lbs)
	Reed valve intake	
	Air cooled two stroke with loop scavenging	
Bore & stroke	67 x 70mm	86.5 x 53mm
Displacement	247ccm	488ccm
Compression ratio	12:1	12:1
Carburetor	Bing type V54/2 Ø38mm	Bing V54/2 Ø40mm
Horse power (DIN)	31kw (42 hp) @8000 RPM	41kw (56 hp) @6800 RPM
Fuel	High octane, (92+), oil mix 20:1 Bel-Ray MC3, 40:1-50:1 Bel-Ray MC1 + or 2 stroke oil with recommended mix.	
Intake system	Large volume foam filter in large air box.	
Exhaust system	High pipe with removable high performance muffler.	
Ignition	Pointless Thyristor - Ignition (MHKZ), Motonlat	
Ignition timing (BTDC)	0.4 ± 0.1mm	2.0 ± 0.1mm
Spark plug	Champion M2 or NGK B5ES	
Clutch	Multiplate, oil bath clutch with friction clutch plates	Cushion drive clutch housing.
Primary ratio	69/24 = 2.28	66/31 = 2.13
Final drive ratio	52/14 = 3.71	52/14 = 3.71
	Optional sprockets 12T, 13T, optional rear wheel sprocket 56T/54T.	
	Dog shifting 5 speed gear box with mainshaft, and output shaft.	Dog shifting 4 speed gear box with mainshaft, and output shaft
Shifting	With 3 shift forks, shifting drum operated through shifting cam with shifting ratchet. Left foot operated.	With 2 shift forks, shifting drum operated through shifting cam with shifting ratchet. Left foot operated.
Gear Ratios:	250 Spider	490 Spider
Type of Gear	C Internal (Overall)	FL FK
1st Gear	2.07(22.07)	2.07(16.34) 2.07(16.34)
2nd Gear	1.61(17.20)	1.56(12.30) 1.56(12.30)
3rd Gear	1.24(13.22)	1.19(9.41) 1.24(9.79)
4th Gear	1.04(11.14)	0.96(7.58) 1.00(7.91)
5th Gear	0.88(9.40)	
Gear lube	SAE 20W-50 motor oil-650cc	
Primary drive	Straight cut gear drive	
Drive chain	5/8 x 1/4" 118 links	5/8 x 1/4" 118 links
Front suspension	Single loop chrome - moly tubing divided into 2 lower down tube single shock frame. Hydraulic telescopic forks with 42mm fork tubes. Aluminum fork sliders, progressive operating dampers, progressive spring, with compressed air.	
Front wheel travel	310mm(12.2")	
Spring, damping	Progressive wound spring - additional air pressurized with 10-14 psi. Hydraulic damper with rebound spring.	
Oil capacity	Approximately 535 cc hydraulic oil per leg. HL25 or AFT (SAE 10) Bel-Ray LT100 or LT200 Oil level measures 16cm from top of the fork tubes.	
Steering head	Covered tapered roller bearings, play free. Adjust without tension.	
Rear suspension	Dual control suspension. Swingarm mounted with needle bearings and sealed by o-rings.	
Rear shocks	Pressurized reservoir Ohlins gas shocks with floating piston in reservoir. Length 474mm (18.66"). Spindle travel 100mm. Adjustable rebounding damping.	
Rear wheel travel	325mm (12.8")	
Front brake	Drum brake - 136 Ømm. Brake shoes 25mm wide. Operated by right hand.	
Rear brake	Drum brake - 160 Ømm. Brake shoes 30mm wide. Operated by right foot.	
Front tire	3.00 x 21	
Rear tire	4.25 x 18	
Tank	Centrifugal molding plastic tank. 9.5 lt. (2.5 gal)	
Color	Spider red (frame, tank, fenders, side panels)	

Technical specifications are subject to change without notice.



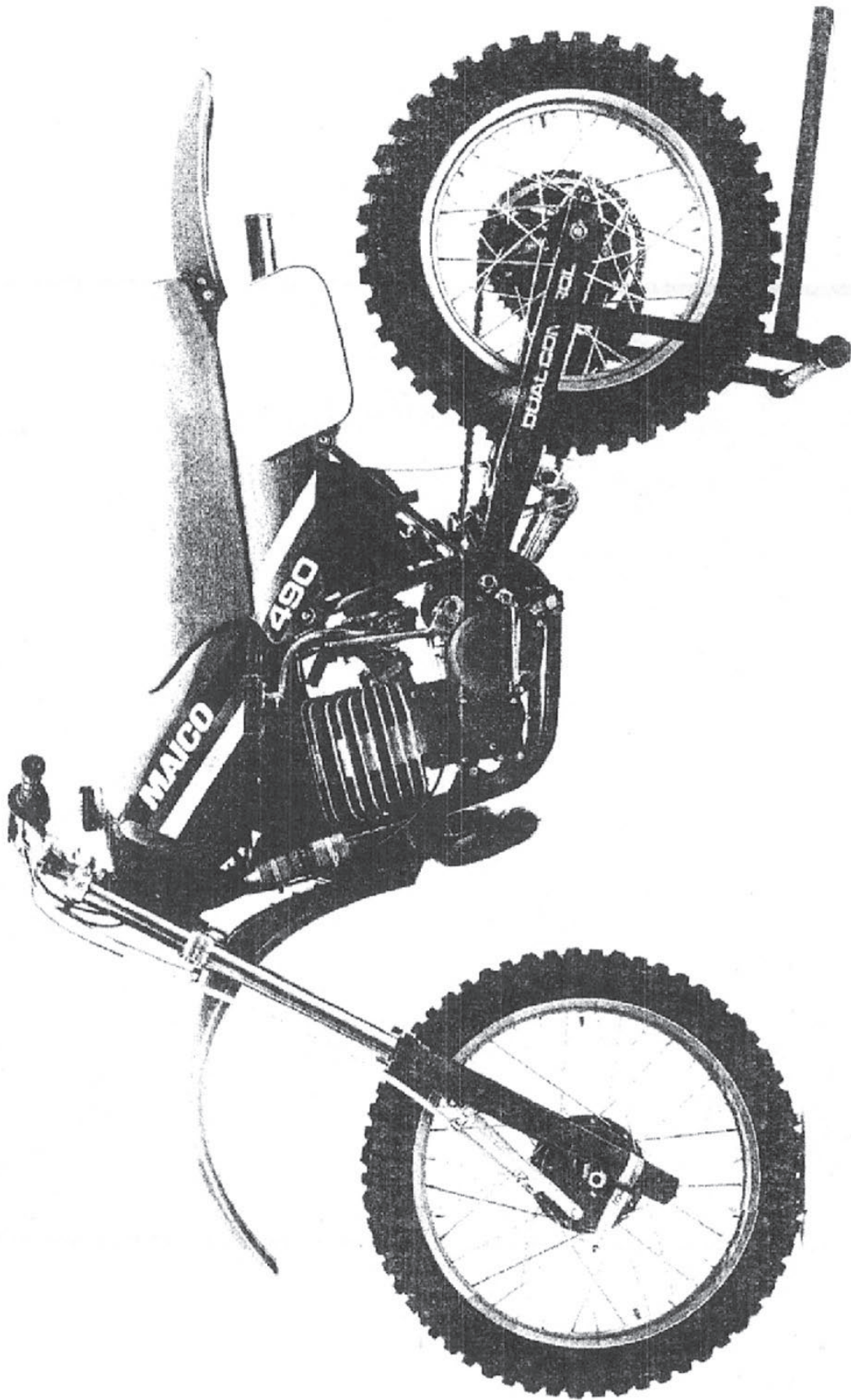

MAICO USA, Inc., 1256 Progress Rd., Suffolk, Virginia 23134  
MAICO WEST, 110 Santa Anita Ave., Burbank, California 91502



**MAICO**  
always a step ahead!





11.0 Explosionszeichnung mit Legende  
11.1 Fahrwerk, Räder

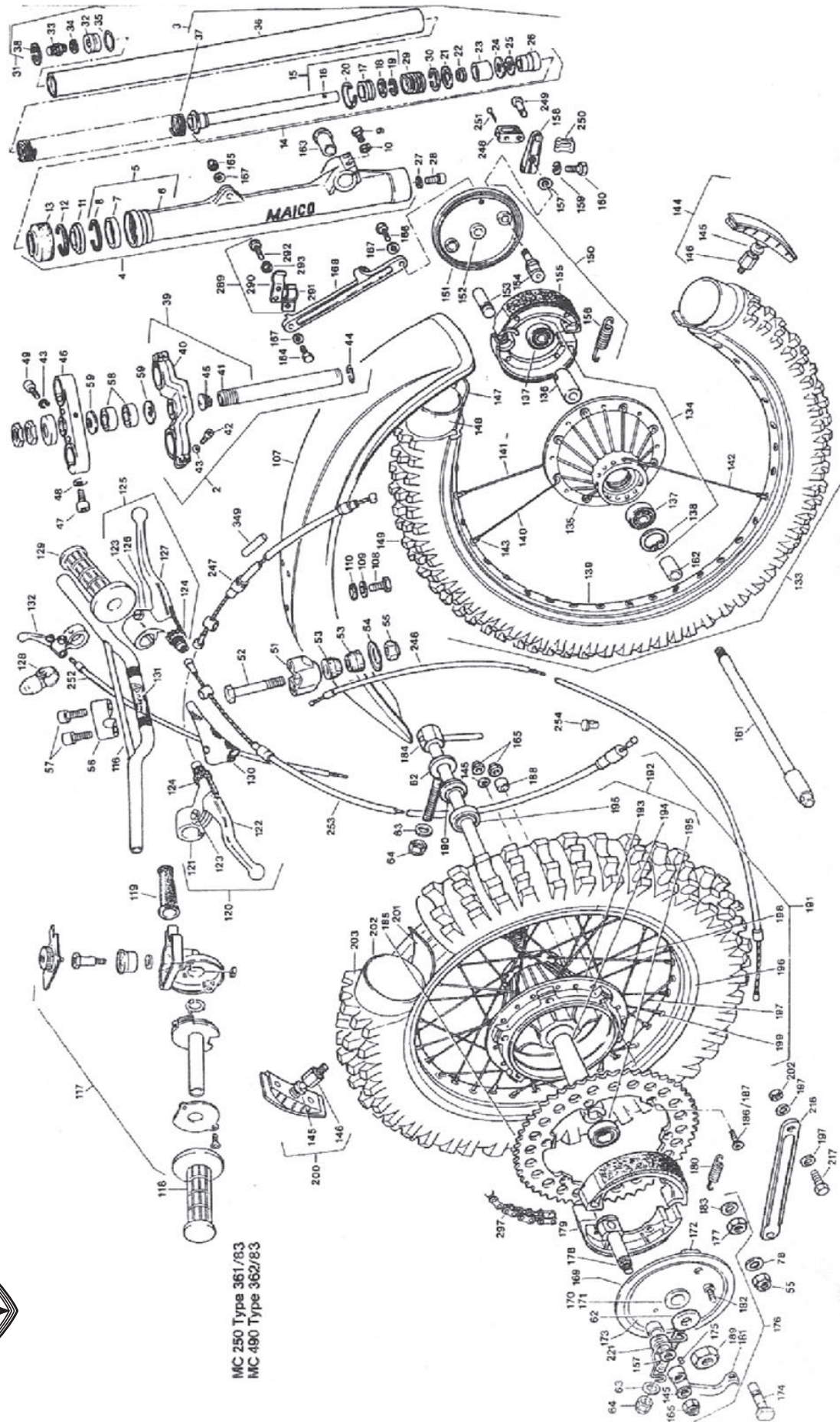

MC 250 Type 361/83  
MC 490 Type 362/83





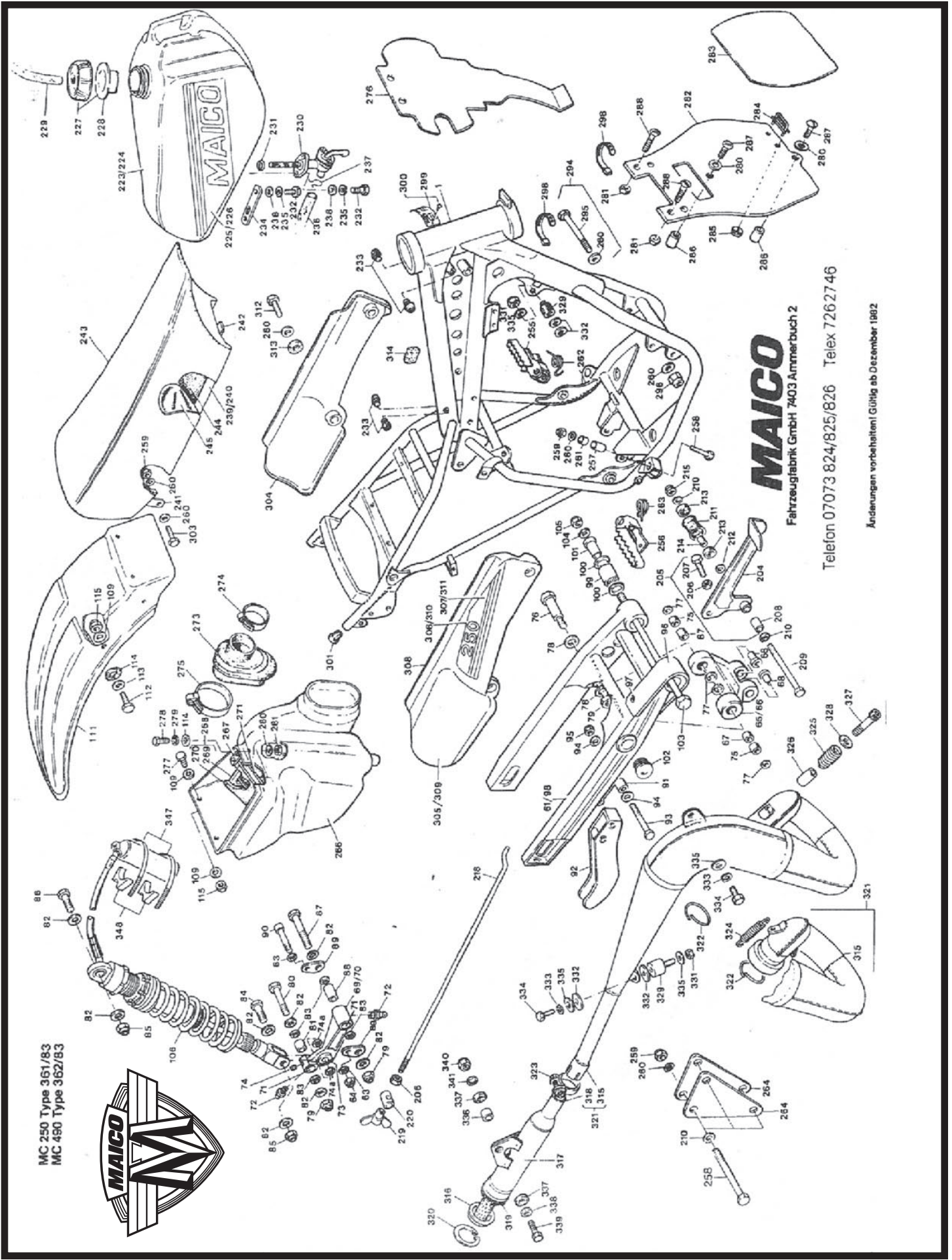

MC 250 Type 361/83  
MC 450 Type 362/83



**MAICO**

Fahrzeugfabrik GmbH 7403 Ammerbuch 2

Telefon 07073 824/825/826 Telex 7262746

Änderungen vorbehalten! Gültig ab Dezember 1982



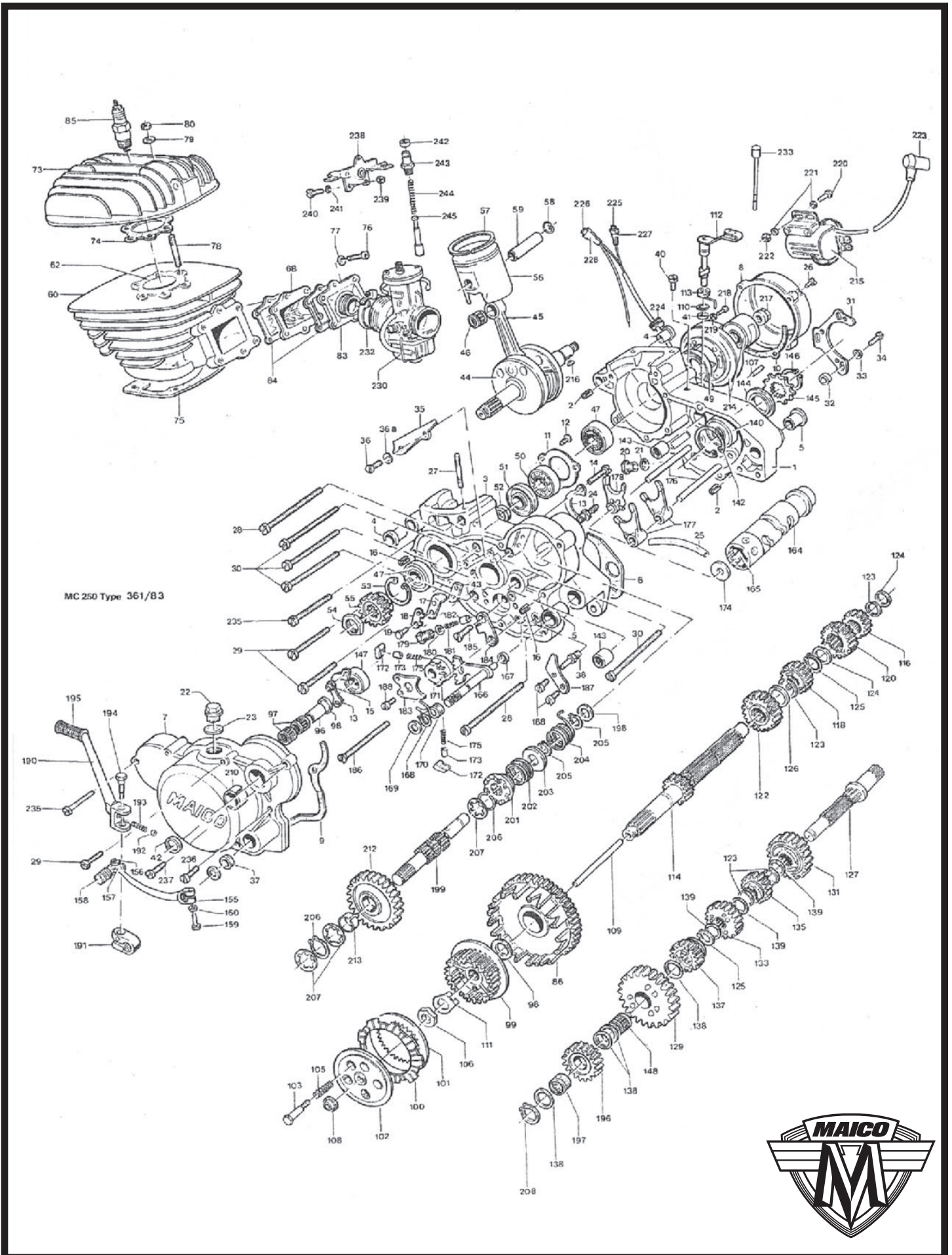





Bild Nr.	EDV Nr.	Bezeichnung Description	Typ 361 MO 250	Typ 362 MO 490	Bild Nr.	EDV Nr.	Bezeichnung Description	Typ 361 MO 250	Typ 362 MO 490
1	7995	Rahmen	1	1	62	7841	Kettenspanner	2	2
2	7472	Frame	1	1	63	1734	Chain tensioner	4	4
3	7480	Telegabel kpl.	2	2	64	1692	Scheibe B 8,4 DIN 125	3	3
4	6631	Gabelholm kpl.	2	2	65	7844	Washer	1	1
5	6626	Fork leg cpl.	2	2	66	7845	Sicherungsmutter NM 8 DIN 980	1	1
6	6630	Gleitrohr vollst.	2	2	67	7846	Securing nut	2	2
7	6436	Fork slider cpl.	2	2	68	7847	Gelenkgabel vollst.	1	1
8	6437	Gleitrohr mit Buchse	2	2	69	7848	Joint fork cpl.	1	1
9	1571	Fork slider with bush	2	2	70	7849	Gelenkgabel	1	1
10	1510	Führungsbuchse	2	2	71	7424	Joint fork	4	4
11	6439	Guide bush	2	2	72	7850	Lagerbuchse	2	2
12	6440	Sprengring	2	2	73	7427	Bundbuchse	1	1
13	6828	Circclip	4	4	74	1465	Bush	1	1
14	7478	Sechskantschraube M 6 x 30 DIN 931	4	4	75	6065	Gelenkhebel vollst.	2	2
15	7477	Hexagon screw	4	4	76	7851	Toggle arm cpl.	1	1
16	6447	Federring B 6 DIN 128	4	4	77	7852	Gelenkhebel	2	2
17	6439	Spring ring	4	4	78	7853	Toggle arm	4	4
18	6440	Stangendichtung	2	2	79	1694	Lagerbuchse	2	2
19	6828	Sealing ring for fork	2	2	80	7854	Bush	4	4
20	6437	Sprengring SB 55 x 1,5	2	2	81	7432	Schmierrippel AM 6	1	1
21	6828	Circclip	2	2	82	1737	Nipple	1	1
22	6427	Hutmanschette	2	2	83	7550	Gelenklager	4	4
23	7478	Fork wiper	2	2	84	7546	Hinge bearing	1	1
24	7477	Dampfer vollst.	2	2	85	1727	Gewindestift M 5 x 4	2	2
25	7475	Dampfer cpl.	2	2	86	7855	Pin	2	2
26	7475	Dampferrohr vollst.	2	2	87	7856	O-Ring Ø 12,37 x 2,62	2	2
27	6447	Dampferrohr gelötet	2	2	88	7857	O-Ring	2	2
28	6448	Dampferkolben	2	2	89	7858	Gelenkbuchse	2	2
29	6448	Dampfer piston	2	2	90	1598	Bush	2	2
30	6449	Scheibe 23,9 x 28,2 x 0,9	2	2	91	7864	Schraube	4	4
31	6449	Washer	2	2	92	7859	screw	4	4
32	6450	Sprengring SW 24	2	2	93	1573	Dichtungerring	1	1
33	6426	Circclip	2	2	94	1732	Sealing ring	4	4
34	6454	Kolbenring	2	2	95	1732	Scheibe B 10,5 DIN 125	4	4
35	6426	Piston ring	2	2	96	7854	Washer	4	4
36	6454	Ventileits	2	2	97	1694	Sicherungsmutter NM 10 x 1 DIN 980	1	1
37	6427	Valve seat	2	2	98	7854	Securing nut	1	1
38	6427	Valve	2	2	99	7432	Gabelbolzen	1	1
39	6427	Dämpfereinsatz	2	2	100	1930	Bolt	1	1
40	6456	Dampfer insert	2	2	101	1931	Gelenkbuchse	1	1
41	6457	Scheibe 29,9 x 36,7 x 0,2	2	2	102	7863	Bush	1	1
42	6457	Washer	2	2	103	3937	Federbolzen	1	1
43	6458	Sicherungsring 37 x 1,5	2	2	104	1718	Hebellagerbolzen	1	1
44	6458	Securing ring	2	2	105	5011	Bolt	1	1
45	6458	Dampferrohrhülse	2	2	106	7865	Distanzbuchse	1	1
46	6459	Bush for damper tube	2	2	107	7895	Spacer bush	2	2
47	6459	Dichttring A 10 x 15 DIN 7603	2	2	108	1569	Stützasche	2	2
48	1655	Sealing ring	2	2	109	1750	Supportring loop	1	1
49	7479	Innensechskantschraube M 10 x 25	2	2	110	2708	Sechskantschraube M 8 x 60 DIN 931	1	1
50	7479	Inner hexagon screw	2	2	111	7896	Hexagon screw	1	1
51	6428	Counter spring	2	2	112	1568	Distanzrohr für Kettenführung	1	1
52	6428	Sprengring SB 58	2	2	113	1732	Spacer tube	1	1
53	6429	Circclip	2	2	114	2708	Kettenführung für 56/54 Z.	1	1
54	6429	Verschlußstopfen	2	2	115	1690	Chain guide for 56/54 teeth	nB	nB
55	6431	Plug	2	2	116	7861	Kettenführung für 52/50 Z.	1	1
56	6431	Verschlußstopfen	2	2	117	7861	Chain guide for 52/50 teeth	1	1
57	2184	Luftventil kpl.	2	2	118	1573	Sechskantschraube M 6 x 50 DIN 931	1	1
58	277	Valve cpl.	2	2	119	1732	Hexagon screw	1	1
59	6464	Dichttring A 8 x 11,5	2	2	120	1732	Scheibe B 6,4 DIN 125	1	1
60	6464	Sealing ring	2	2	121	1690	Washer	1	1
61	6464	Präzisions-O-Ring 29,74 x 3,53	2	2	122	1690	Sicherungsmutter NM 6 DIN 980	1	1
62	6637	O-Ring	2	2	123	7861	Securing nut	1	1
63	7481	Standrohr	2	2	124	7861	Gleitschutzplatte	1	1
64	7481	Main tube	2	2	125	1514	Protection plate	2	2
65	7481	Gabelfeder	2	2	126	7862	Senkschraube M 6 x 10 DIN 963	2	2
66	6457	Fork spring	2	2	127	7862	Countersunk screw	1	1
67	6457	Sicherungsring 37 x 15 DIN 472	2	2	128	9932	Hinterradschwinge mit Lagern	1	1
68	7473	Securing ring	1	1	129	9932	Rear wheel swing arm with bearings	2	2
69	6640	Querhaupt unten kpl.	1	1	130	1930	Nadelhülse HK 2030	2	2
70	6640	Lower cross head cpl.	1	1	131	1930	Needle bush	4	4
71	6640	Querhaupt unten	1	1	132	1931	Präzisions-O-Ring	2	2
72	6640	Lower cross head	1	1	133	1931	O-Ring	2	2
73	7483	Steuerrrohr	1	1	134	1931	Buchse für Hinterradschwinge	2	2
74	1649	Steering tube	1	1	135	1931	Bush for rear swing arm	2	2
75	1649	Innensechskantschraube M 8 x 45 DIN 912	4	4	136	7863	Rundstopfen	2	2
76	1511	Inner hexagon screw	5	5	137	3937	Flug	1	1
77	1511	Federring B 8 DIN 128	5	5	138	1718	Achse für Schwinge	1	1
78	7484	Spring ring	1	1	139	1718	Spindle	1	1
79	7490	Sprengring SW 27	1	1	140	1718	Federscheibe B 14 DIN 137	1	1
80	7490	Circclip	1	1	141	5011	Spring washer	1	1
81	7490	Kunststoffstopfen	1	1	142	5011	Sicherungsmutter NM 14 x 1,5 DIN 980	1	1
82	7474	Plastic plug	1	1	143	7865	Securing nut	1	1
83	3270	Querhaupt oben	1	1	144	7865	Federbein kpl. Corte & Coeso	nB	nB
84	3270	Upper cross head	1	1	145	7866	Federbein kpl. CHLINS	nB	nB
85	3270	Innensechskantschraube M 10 x 40	2	2	146	7895	Dampfer cpl.	1	1
86	1512	Inner hexagon screw	2	2	147	7895	Dampfer cpl.	1	1
87	1512	Federring B 10 DIN 128	2	2	148	1569	Schutzblech vorn	1	1
88	1548	Spring ring	1	1	149	1569	Front fender	4	4
89	1648	Innensechskantschraube M 8 x 40	1	1	150	1750	Sechskantschraube M 6 x 20 DIN 931	4	4
90	6474	Inner hexagon screw	2	2	151	1750	Scheibe 6,4 DIN 9021	4	4
91	6474	Steuerkopfmutter (wahlweise)	nB	nB	152	2708	Washer	4	4
92	6479	Steering head nut (optionally)	2	2	153	2708	Gummisohle	4	4
93	6479	Lenkerklemmstück unten	2	2	154	7896	Rubber washer	1	1
94	1619	Lower handle bar clamp	2	2	155	1568	Hinterradkotflügel	1	1
95	6005	Sechskantschraube M 10 x 55	4	4	156	1568	Rear fender	1	1
96	6005	Hexagon screw	4	4	157	1732	Sechskantschraube M 6 x 18	4	4
97	6642	Gummipuffer	4	4	158	1732	Hexagon screw	8	8
98	6642	Rubber buffer	2	2	159	2708	Scheibe B 6,4 DIN 125	8	8
99	6642	Scheibe	2	2	160	2708	Washer	4	4
100	1693	Washer	2	2	161	2708	Gummisohle	4	4
101	1693	Sicherungsmutter NM 10 DIN 980	2	2	162	1690	Rubber washer	4	4
102	6478	Securing nut	2	2	163	1690	Sicherungsmutter NM 6 DIN 980	4	4
103	6478	Lenkerklemmstück oben	2	2	164	6668	Securing nut	1	1
104	1629	Upper handle bar clamp	4	4	165	6668	Lenkerbügel	1	1
105	1629	Innensechskantschraube M 8 x 30	4	4	166	7896	Handlebar	1	1
106	1629	Inner hexagon screw	4	4	167	7896	Gasgriff kpl.	1	1
107	3297	Kegelrollenlager	2	2	168	7893	Throttle grip cpl.	1	1
108	3297	Roller bearing	2	2	169	2212	Griffbezug	1	1
109	3296	Nilosring	2	2	170	2212	Grip cover	1	1
110	6480	Nilos ring	1	1	171	2212	Gummikappe	1	1
111	6480	Cover plate	1	1	172	2215	Rubber cap	1	1
112	7840	Hinterradschwinge	1	1	173	2215	Kupplungshebel kpl.	1	1
113	7840	Rear wheel swing arm	1	1	174	2215	Clutch lever cpl.	1	1

614 Nr.	EDV Nr.	Bezeichnung Description	Typ 361 MC 250	Typ 362 MC 490	614 Nr.	EDV Nr.	Bezeichnung Description	Typ 361 MC 250	Typ 362 MC 490
121	2215	Kupplungshebelleitenklotz Hinge for clutch lever	1	1	179	184	Bremssacke Brake shoe	2	2
122	2216	Kupplungshebel leer Clutch lever	1	1	180	1323	Rückstufefeder Tension spring	2	2
123	135	Hebel schraube mit Mutter Lever screw with nut	2	2	181	3190	Bremshebel für Hinterradnabe Brake lever for rear hub	1	1
124	212	Stellschraube mit Mutter Adjusting screw with nut	2	2	182	3210	Innen-Sechskantschraube M 10 x 40 x 32 Inner hexagon screw	1	1
125	2218	Bremshebel kpl. Brake lever cpl.	1	1	183	1715	Feder scheibe B 10 DIN 157 Spring washer	1	1
126	2217	Bremshebel gelenkstück Hinge of brake lever	1	1	184	7903	Steckachse hinten rear axle	1	1
127	2219	Handbremshebel leer Hand brake lever only	1	1	185	7522	Zahnkranz 52 Z Sprocket	1	1
128	2220	Kurschlußknopf kpl. Kill button	1	1	7521	Zahnkranz 54 Z Sprocket	nB	nB	
129	7092	Fastgriff Rubber grip	1	1	7523	Zahnkranz 50 Z Sprocket	nB	nB	
130	7091	Schutzkappe Lever cover	2	2	7514	Zahnkranz 56 Z Sprocket	nB	nB	
131	6698	Schrifttausch Sticker	1	1	186	1880	Genkschraube m. Innensechsk. M 8 x 50 Countersunk screw with inner hexagon	3	3
132	7889	Dekohebel kpl. Lever for decompressor	-	1	187	1803	Genkschraube m. Innensechsk. M 8 x 40 Countersunk screw with inner hexagon	3	3
	7890	Schraubnippel für Dekohebel Nipple	-	1	188	6696	Distanzhülse Spacer bush	3	3
133	7955	Vorderrad leer Front wheel only	1	1	189	8484	Sicherungsmutter NM 16 x 1,5 DIN 980 Securing nut	1	1
134	6671	Vorderradnabe mit Lager Front wheel hub with bearing	1	1	190	7907	Distanzstück Spacer part	1	1
135	6670	Vorderradnabe leer Front wheel hub only	1	1	191	7897	Hinterrad leer Rear wheel only	1	1
136	2428	Distanzrohr für Vorderradnabe Spacer tube for front wheel hub	1	1	192	5684	Hinterradnabe vollst. Rear wheel hub cpl.	1	1
137	2427	Rillenkugellager 6202 RS DIN 625 Ball bearing	2	2	193	6689	Hinterradnabe leer Rear wheel hub only	1	1
138	1153	Sicherungsring 35 x 1,5 DIN 472 Securing ring	1	1	194	3276	Distanzrohr hinten Spacer tube rear	1	1
139	7956	Kim Tiefbettfelge 21 "	1	1	195	205	Rillenkugellager 6303 2 RS C 3 Ball bearing	2	2
140	7957	Speiche 4 x 3,5 x 4 x 230 - 80° Spoke	0	0	196	7899	Tiefbettfelge 18 " Rim	1	1
141	7958	Speiche 4 x 3,5 x 4 x 230 - 100° Spoke	9	9	197	7397	Speiche ED 4,5 x 4 x 163 Spoke	10	10
142	6659	Speiche 4 x 3,5 x 4 x 244 - 155° Spoke	1A	1B	198	7398	Speiche ED 4,5 x 4 x 209 Spoke	10	10
143	7404	Nippel M 4,5 Nipple	36	36	199	2408	Nippel M 4,5 Nipple	36	36
144	7960	Reifenhalter kpl.m. Mutter u. Scheibe Tire holder cpl. with nut and washer	1	1	200	7909	Reifenhalter kpl. m. Mutter u. Scheibe Tire holder cpl. with nut and washer	1	1
145	1754	Scheibe B 8,4 DIN 125 Washer	6	6	201	2005	Felgenband 18 " Tire flap	1	1
146	289	Mutter für Reifenhalter Nut for tire holder	2	2	202	2015	Schlauch 4,50 x 18 " Hose	1	1
147	2004	Felgenband 21 " Tire flap	1	1	203	2008	Reifen 4.50 x 18 " Tire	1	1
148	2002	Schlauch 5,00 - 21 " Hose	1	1	7923	Reifen 5.00 x 18 " Pirelli Tire	nB	nB	
149	2003	Reifen 3.00 - 21 " Geil. Deck Tire	nB	nB	7965	Reifen 5.00 x 18 " Sand Crown Tire	nB	nB	
	7962	Reifen 3.20 - 21 " Pirelli Tire	nB	nB	7966	Reifen 4.50 x 18 " Sand Crown Tire	nB	nB	
	7963	Reifen 3.20 x 21 " Sand Crown Tire	nB	nB	204	7510	Außerbremshebel geschweigt Foot brake lever	1	1
	7964	Reifen 3.00 x 21 " Sand Crown Tire	nB	nB	205	7715	Außerbremshebel vollst. Foot brake lever cpl.	1	1
150	6144	Bremsankerplatte kpl. Brake plate cpl.	1	1	206	1667	Sechskantsmutter M 6 DIN 934 Hexagon nut	1	1
151	2236	Bremsankerplatte leer (mit Buchse) Brake plate only (with bush)	1	1	207	7916	Sechskantschraube M 6 x 30 DIN 933 Hexagon screw	1	1
152	2238	Ankerplattenbuchse Buchung	1	1	208	5702	Lagerbuchse für Bremshebel Bush for brake lever	1	1
153	2418	Bremsbuchsendrehbolzen Pivot bolt	1	1	209	7917	Sechskantschraube M 8 x 100 DIN 931 M 8 x 100 DIN 931	1	1
154	2419	Bremschlüssel Brake toggle	1	1	210	1754	Scheibe B 8,4 DIN 125 Washer	2	2
155	4322	Bremsbacke Brake shoe	2	2	211	7991	Umlenkrolle Holler	1	1
156	6148	Stegfeder für Bremsbacke Spring for brake shoe	2	2	212	7996	Distanzscheibe Spacer washer	1	1
157	187	Gummischeibe Rubber washer	2	2	213	7993	Rillenkugellager 608 2 RS DIN 625 Ball bearing	2	2
158	6145	Bremshebel vorn Brake lever front	1	1	214	7992	Distanzbuchse Spacer bush	1	1
159	1704	Federling B 6 DIN 127 Spring ring	1	1	215	1692	Sicherungsmutter NM 6 DIN 900 Securing nut	2	2
160	1570	Sechskantschraube M 6 x 25 DIN 933 Hexagon screw	1	1	216	1970	Bremsanker hinten Brake axle rear	1	1
161	2247	Steckachse vorn Front axle	1	1	217	7921	Sechskantschraube M 8 x 60 DIN 933 Hexagon screw	1	1
162	2250	Distanzbuchse Spacer bush	1	1	218	7936	Zugstange für Hinterradbremse Rear brake rod for rear brake	1	1
163	2430	Gewindebuchse Bush	1	1	219	243	Flügelmutter Nut	1	1
164	1554	Sechskantschraube M 8 x 40 DIN 931 Hexagon screw	1	1	220	244	Nippelaufnahme Nipple holder	1	1
165	1692	Sicherungsmutter NM 8 DIN 980 Securing nut	6	6	221	7922	Bremsebleifeder Brake lever spring	1	1
166	1584	Sechskantschraube M 8 x 20 DIN 933 Hexagon screw	1	1	222	406	Benzinschlauch Ø 7 x 2 Hose	x	x
167	1714	Scheibe Ø 8,4 x 20 x 1,6 Washer	3	3	223	7924	Tank mit Dekor Tank with decal	1	1
168	6147	Bremsanker vorn Brake stay front	1	1	224	6508	Tank Tank	1	1
169	7900	Bremsankerplatte mit Einpressteilen Brake plate	1	1	225	7927	Tankdekor links Tank decal left	1	1
170	7901	Distanzbuchse für Ankerplatte Spacer bush for brake plate	1	1	226	7928	Tankdekor rechts Tank decal right	1	1
171	183	Distanzbuchse für Ankerplatte Spacer bush for brake plate	1	1	227	6515	Tankdeckel kpl. tank cap cpl.	1	1
172	3187	Ankerplatte hinten leer Brake plate rear only	1	1	228	6516	Deckeldichtung Cover gasket	1	1
173	3188	Abdeckblech Cover plate	1	1	229	6517	Schlauch Hose	1	1
174	3189	Bremsbacken-Drehbolzen Pivot bolt	1	1	230	6509	Benzinhahn Gas tap	1	1
175	1901	Nalhrundkerbnagel Ø 3 x 8 DIN 1476 Oval head nail	1	1	231	6510	O-Ring O-ring	1	1
176	7902	Bremsankerplatte kpl. Brake plate cpl.	1	1	232	1525	Sechskantschraube M 6 x 14 DIN 933 Hexagon screw	4	4
177	1674	Sechskantsmutter M 10 DIN 934 Hexagon nut	1	1	233	6531	Anschlagpuffer Rubber buffer	4	4
178	151	Bremschlüssel Brake toggle	1	1	234	7994	Lasche Holding plate	1	1

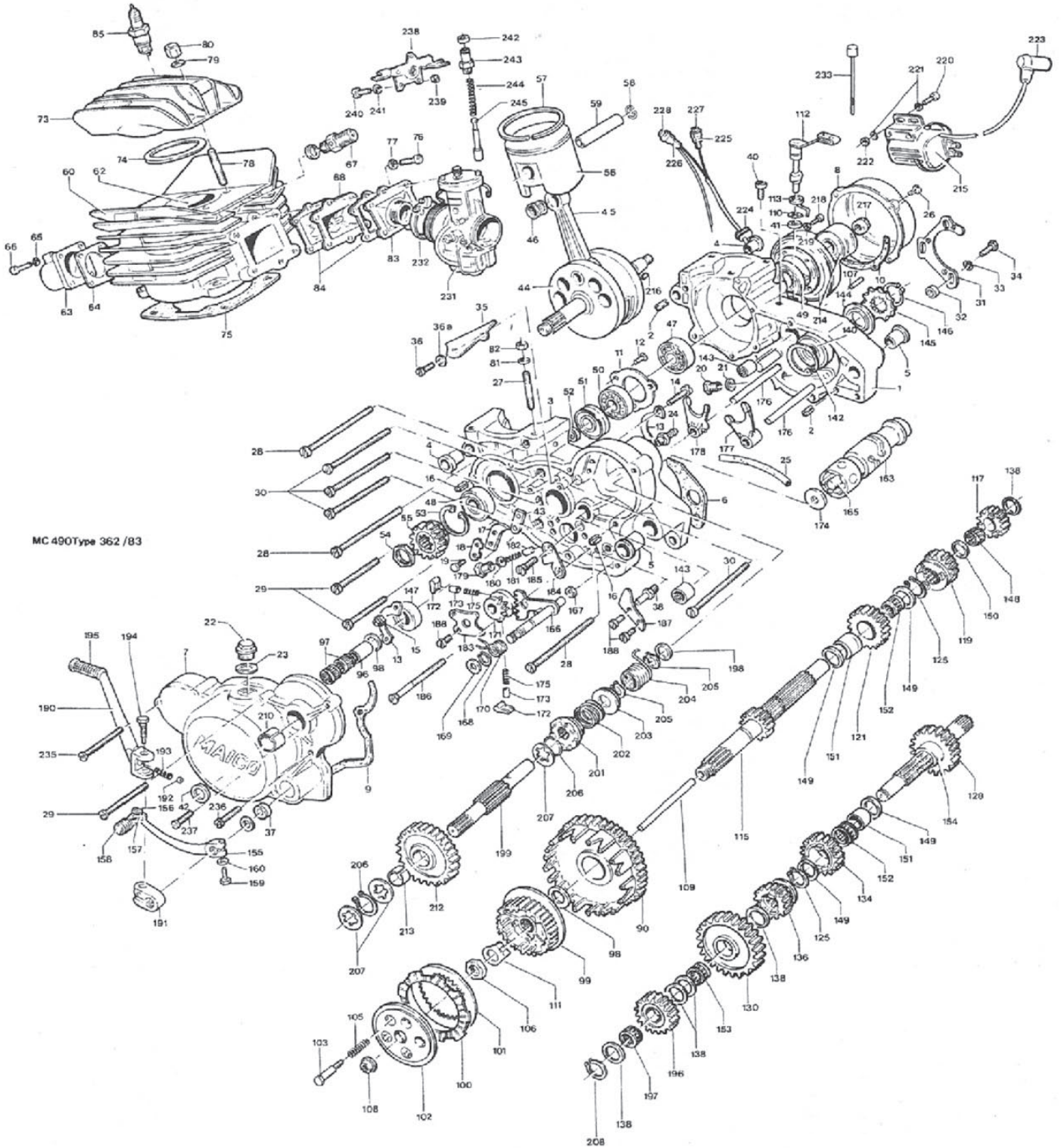

Bild Nr.	EDV Nr.	Bezeichnung Description	Typ 361 No. 250	Typ 362 No. 490	Bild Nr.	EDV Nr.	Bezeichnung Description	Typ 361 No. 250	Typ 362 No. 490
235	1704	Federtring B 6 DIN 127 Spring ring	4	4	293	1704	Federtring B 6 DIN 127 Spring ring	1	1
236	406	Beschießschlauch 7 x 2 Hose	X	X	294	6254	Satz Motorabflachschrauben Set motor mount bolts	1	1
237	2852	Schlauchklemmung Hose clamp	2	2	295	1610	Sechskantschraube M 3 x 120 DIN 934 Hexagon screw	2	2
238	1730	Scheibe B 6,4 DIN 9021 Washer	2	2	296	1700	Sicherungsmutter NM 6 DIN 980 Securing nut	2	2
239	7941	Sitzbankwanne mit Füßel und Haltefl. Seat base with clamp and bracket	1	1	297	3703	Kette 5/8" ± 1/4" 118 Glieder m. Schloß Chain with lock	1	1
240	6747	Sitzbankwanne leer Seat base only	1	1	298	325	Kabelbinder Rubber cable clip	2	2
241	6748	Sitzbankbügel Seat bracket	1	1	299	325	Typenschild Identification plate	1	1
242	6751	Halteleuchte Clamp holder	1	1	300	1900	Halbernderbolmutter 2 x 4 DIN 1476 Oval head nut	2	2
243	7942	Sitzbank Kpl. (niedere Form) Seat cpl. (low)	1	1	301	6565	Versteckknöpfchen Rubber cap	2	2
	7943	Sitzbank Kpl. (hohe Form) Seat cpl. (high)	nB	nB	302	6760	Kabelbinder 5,6 x 277 Rubber cable clip	2	2
244	7943	Polster (niedere Form) Seat padding (low)	1	1	303	1547	Sechskantschraube M 3 x 16 DIN 934 Hexagon screw	2	2
	7946	Polster (hohe Form) Seat padding (high)	nB	nB	304	7971	Seitennummernschild links Side panel left	1	1
245	7944	Bezug (niedere Form) Seat cover (low)	1	1	305	7977	Abziehfolie 310mm grün Decal left green	1	-
	7947	Bezug (hohe Form) Seat cover (high)	nB	nB	7955		Abziehfolie links gelb Decal left yellow	-	1
246	7954	Gehäuse Kpl. Case shell	1	1	306	6747	Schriftzug 250 Sticker	1	-
247	7598	Bremszug Kpl. Brake cable	1	1	6755		Schriftzug 490 Sticker	-	1
248	6151	Bremszugaufnahme Brake cable intake	1	1	7979		Schilderkegel links Decal left	1	1
249	6152	Bolzen mit Kopf Bolt with head	1	1	7980		Abziehfolie rechts grün Decal right green	1	-
250	6153	Bolzen-Sicherung Clip for bolt	1	1	7987		Abziehfolie rechts gelb Decal right yellow	-	1
251	1897	Splint 3,2 x 25 DIN 94 Split pin	1	1	6747		Schriftzug 250 Sticker	1	-
252	315	Deckungsblech Decompression cable	-	1	6755		Schriftzug 490 Sticker	-	1
253	7930	Kupplungszug Clutch cable	1	1	7981		Schilderkegel rechts Decal right	1	1
254	7951	Nippelhalter Nipple holder	1	1	309	3050	Sechskantschraube M 6 x 16 DIN 934 Oval head screw	4	4
255	6751	Podest links Foot rest left	1	1	313	2708	Gummischeibe Rubber washer	4	4
256	6752	Podest rechts Foot rest right	1	1	314	6753	Gummirolle Wellenkleben 25 x 5 Rubber	2	2
257	6753	Lagerbuchse Bearing bush	2	2	315	3955	Auspuff geschweißt Exhaust welded	1	-
258	1593	Sechskantschraube M 8 x 60 DIN 934 Hexagon screw	3	3	3979		Auspuff geschweißt Exhaust welded	-	1
259	1602	Sicherungsmutter NM 6 DIN 980 Securing nut	2	2	316	3954	Endrohr gelb Tail pipe soldered	1	-
260	1734	Scheibe M 8,4 DIN 125 Washer	20	20	3980		Endrohr gelbsilb Tail pipe soldered	-	1
261	6750	Dichtungsbuchse Spacer bush	2	2	3981		Schilderkegel Silencer conical	-	1
262	6739	Polsterelemente links Foot rest spring left	1	1	318	3961	Schilderkegel Silencer conical	1	-
263	6740	Polsterelemente rechts Foot rest spring right	1	1	3981		Schilderkegel geschweißt Silencer welded	-	1
264	7949	Stützblech für Zylinderkopf Supporting plate for cylinder head	2	-	318	3966	Schilderkegel vollst. Silencer cpl.	1	-
	7935	Stützblech für Zylinderkopf Supporting plate for cylinder head	-	2	3982		Schilderkegel vollst. Silencer cpl.	-	1
265	1598	Sechskantschraube M 8 x 60 DIN 934 Hexagon screw	3	3	319	4884	Füllmaterial Exhaust packing	1	-
266	7969	Luftfilterkasten mit Haltewinkel Air filter box	1	1	6851		Füllmaterial Exhaust packing	-	1
267	7968	Haltewinkel Clamp	1	1	320	3968	Sicherungsring Circlip	1	1
268	7434	Filterpatrone Kpl. Filter element cpl.	1	1	321	3967	Auspuffanlage vollst. Exhaust system cpl.	1	-
269	7435	Filterkorb Filter cage	1	1	3985		Auspuffanlage Exhaust system cpl.	-	1
270	7436	Filtereinsatz Air filter foam	1	1	392	896	Auspuffrohr Exhaust cord	1	X
271	7437	Federbügel vollst. Holding wire cpl.	1	1	323	5474	Gummischeibe Clamp	1	1
272	7973	Ansaugverbindung Intake flange	1	1	324	6866	Sugfeder Tension spring	2	-
273	683	Schlauchklemme Clamp	1	1	325	6275	Bruckfeder Spring	-	1
274	7451	Schlauchklemme Clamp	1	1	326	6276	Führungsbuchse Guide bush	-	1
275	7948	Spritzwand Splash guard	1	1	327	1523	Innen-Sechskantschraube M 6 x 70 DIN 913 Inner hexagon screw	-	1
276	1569	Sechskantschraube M 6 x 20 DIN 934 Hexagon screw	2	2	328	1750	Scheibe B 6,4 DIN 9021 Washer	-	1
277	1570	Hexagon screw Sechskantschraube M 6 x 25 DIN 934 Hexagon screw	2	2	329	1166	Schwammstoffpuffer Silent bloc for exhaust	2	2
278	1732	Scheibe B 6,4 DIN 125 Washer	4	4	330	1732	Scheibe B 6,4 DIN 125 Washer	2	2
279	1750	Scheibe B 6,4 DIN 9021 Washer	10	10	331	1690	Sicherungsmutter NM 6 DIN 980 Securing nut	2	2
280	1690	Sicherungsmutter NM 6 DIN 980 Securing nut	6	6	332	5430	Scheibe Washer	4	4
281	7444	Seitennummernschild vorn Front number plate	1	1	333	1510	Federtring B 6 DIN 128 Spring ring	2	2
282	7975	Abziehfolie vorn grün Front decal, green	1	-	334	1525	Sechskantschraube M 6 x 14 DIN 934 Hexagon screw	2	2
	7993	Abziehfolie vorn gelb Front decal yellow	-	1	335	1750	Scheibe B 6,4 DIN 9021 Washer	2	2
283	6247	Führungsbügel Guide plate	1	1	336	6960	Einbaue für Schalldämpferhalter Bush for silencer	1	1
284	6269	Federhalter Spring nut	2	2	337	5245	Gummischeibe Rubber washer	2	2
285	3094	Elektrolinse Lampshade	2	2	338	1759	Scheibe B 7,4 DIN 9021 Washer	1	1
286	1253	Kunststoffschraube Plastic screw	2	2	339	1521	Sechskantschraube M 6 x 25 DIN 934 Hexagon screw	1	1
287	3711	Kunststoffschraube M 6 x 22 Plastic screw	2	2	340	1699	Sicherungsmutter NM 6 DIN 980 Securing nut	1	1
288	6257	Bremszughalter vollst. Brake cable holder cpl.	1	1	341	1734	Scheibe B 8,4 DIN 125 Washer	1	1
289	6258	Bremszughalter Brake cable holder	1	1	-	7359	Werkzeug Set of tools	2	2
290	6255	Klemmblech Clamp plate	1	1	347	7867	Schlauchklemme Clamp	2	2
291	1565	Sechskantschraube M 6 x 12 DIN 934 Hexagon screw	1	1	343	7868	Innenstopfen Rubber cuplet	2	2
					342	2275	Isoliererschlauch 20 x 0,7 Insulating hose	X	X

Bild Nr.	EDV Nr.	Bezeichnung Description	Typ 351 MC 250	Typ 362 MC 490	Bild Nr.	EDV Nr.	Bezeichnung Description	Typ 351 MC 250	Typ 362 MC 490
1	8018	Kurbelgehäuse rechts	1	-	51	547	Wellendichtring 32 x 52 x 7/0	1	1
	8027	Engine case, right	-	1	52	8260	Radial sealing ring	1	-
2	1997	Kurbelgehäuse rechts	2	2		8290	Inner ring	-	1
		Inner ring					Inner ring 25 x 31,45 x 13		
3	8020	Kurbelgehäuse links	1	-	53	6305	Sicherungsring 52 x 2 DIN 472	2	2
	8026	Engine case, left	-	1	54	8255	Mutter auf KW SW 32	1	1
4	1995	Kurbelgehäuse links	4	4	55	8049	Nut on crankshaft	1	-
		Fixing bush				8070	Zahnrad auf KW	-	1
5	1994	Oscillant bush	2	2		8070	Zahnrad auf KW	-	1
6	8021	Gehäusedichtung	1	-	56	8370	Kolben kpl. Ø 66,97	1	-
	8030	Engine case gasket	-	1		8372	Piston cpl.	1	-
7	8024	Gehäusedichtung	1	1		8373	Kolben kpl. Ø 67,17	1	-
		Engine case gasket				8374	Piston cpl.	1	-
8	1991	Kupplungsdeckel	1	1		8375	Kolben kpl. Ø 67,37	1	-
		Clutch cover				8376	Piston cpl.	1	-
9	8023	Limasdeckel	1	1		6813	Kolben kpl. Ø 86,44	-	1
		Ignition case cover				6815	Piston cpl.	-	1
10	1980	Deckeldichtung	1	1		6816	Kolben kpl. Ø 86,64	-	1
		Clutch case gasket				6817	Piston cpl.	-	1
11	1968	Deckeldichtung rechts	1	1		6818	Kolben kpl. Ø 87,04	-	1
		Ignition case gasket, right				6819	Piston cpl.	-	1
12	1795	Lagerhalteblech KW	3	3		57	Kolbenring Ø 67,00	1	-
		Countersunk screw				6184	Piston ring	1	-
13	8008	Lagerhalteblech HW	2	2		6184	Kolbenring Ø 67,20	1	-
		Bearing cover plate				6187	Piston ring	1	-
14	1536	Zylinderschraube M 6 x 25 DIN 84	2	2		2067	Kolbenring Ø 67,40	1	-
		Cylinder screw				6189	Piston ring	1	-
15	1690	Sicherungsmutter NM 6 DIN 980	2	2		6191	Kolbenring Ø 67,60	1	-
		Securing nut				6814	Piston ring	1	-
16	1831	Spannhülse 8 x 10 DIN 7346	2	2		6820	Kolbenring Ø 86,50	-	1
		tension pin				6821	Piston ring	-	1
17	8009	Anlaufblech für Sperrzahnkörper	1	1		6822	Kolbenring Ø 86,70	-	1
		Washer				6823	Piston ring	-	1
18	8010	Sicherungsblech	1	1		6824	Kolbenring Ø 87,30	-	1
		flat washer				6824	Piston ring	-	1
19	1569	Sechskantschraube M 6 x 20 DIN 933	2	2		58	Sprengtring	2	2
		Hexagon screw				59	Clirclip	1	-
20	895	Magnetverschlusschraube	1	1		8371	Kolbenbolzen 18 x 15 x 50	1	-
		Magneto screw cap				555	Kolbenbolzen	-	1
21	410	Dichtring A 14 x 18 DIN 7603	1	1		60	Wrist pin	1	-
		Seal ring				8218	Wrist pin	-	1
22	408	Verachlußschraube M 20 x 1,5 DIN 910	1	1		4172	Zylinder vollst.	1	-
		screw cap				4172	Zylinder vollst. im Austausch	1	-
23	409	Flachdichtring A 20 x 24 DIN 7603	1	1		8295	Zylinder cpl. in exchange	-	1
		seal ring				4179	Zylinder vollst.	-	1
24	1985	Einschraubstutzen	1	1		61	Zylinder cpl. in exchange	-	1
		Breather				62	Zylinder vollst. mit Auspuffstutzen	-	1
25	263	Entlüftungsschlauch	x	x		62	Zylinderbuchse	1	-
		Breather tube				8297	Cylinder bush	-	1
26	1536	Zylinderschraube M 6 x 25 DIN 84	4	4		63	Auspuffstutzen	-	1
		Cylinder screw				64	Exhaust flange	-	1
27	1772	Stiftschraube M 8 x 25 DIN 835	4	-		65	Exhaust adapter gasket	-	4
		Stud				66	Spring ring	-	4
28	1545	Zylinderschraube AM 6 x 80 DIN 84	2	3		67	Innensechskantschraube M 6 x 25	-	4
		Cylinder screw				67	Inner hexagon screw	-	4
29	1541	Zylinderschraube AM 6 x 50 DIN 84	5	2		68	Dekoventil kpl.	-	1
		Cylinder screw				68	Decompression valve cpl.	-	1
30	1519	Zylinderschraube AM 6 x 75 DIN 84	4	4		69	Membrankörper	1	1
		Cylinder screw				70	Reed valve	2	2
31	8011	Schutzhügel	1	1		71	Reed valve tongue	2	2
		Bracket				72	Reed valve stop tongue	2	2
32	8012	Distanzhülse	3	3		73	Linseenschraube M 3 x 8 2 4 DIN 7985	6	6
		Spacer bush				8301	Oval head screw	1	-
33	1510	Federring B 6 DIN 128	3	3		74	Zylinderkopf	-	1
		Spring ring				74	Cylinder head	-	1
34	1571	Sechskantschraube M 6 x 30 DIN 933	3	3		74	Zylinderkopf	1	-
		Hexagon screw				74	Zylinderkopfdichtung	1	-
35	8025	Ölleitblech	1	-		7461	Zylinderkopfdichtung	-	1
	8031	Ölleitblech	-	1		75	Zylinderkopfdichtung	-	1
		Oil guide plate				8222	Zylinderkopfdichtung 0,3 mm dick	nB	-
36	1762	Linsenzylinderschraube AM 5 x 10	2	2		8223	Zylinderfußdichtung 0,5 mm dick	nB	-
		Oval head cylinder screw				8224	Zylinderfußdichtung 0,7 mm dick	nB	-
36a	1711	Federscheibe B 5 DIN 137	2	2		7462	Zylinderfußdichtung 0,3 mm dick	-	nB
		Spring washer				7463	Zylinderfußdichtung 0,5 mm dick	-	nB
37	1865	Wellendichtring AS 12 x 22 x 7	1	1		7464	Zylinderfußdichtung 0,7 mm dick	-	nB
		Seal ring					Cylinder base gasket		
38	8014	Federstift-Rückholfeder	1	1			Cylinder base gasket		
		Spring pin-return spring					Cylinder base gasket		
40	1526	Zylinderschraube M 8 x 10 DIN 84	1	1			Cylinder base gasket		
		Cylinder screw					Cylinder base gasket		
41	8175	Dichtring	1	1			Cylinder base gasket		
		Seal ring					Cylinder base gasket		
42	1866	Wellendichtring	1	1			Cylinder base gasket		
		Sealing ring					Cylinder base gasket		
43	8016	Anschlagblech	1	1			Cylinder base gasket		
		Stop plate					Cylinder base gasket		
44	8254	Kurbelwelle vollst.	1	-			Cylinder base gasket		
	8284	Crankshaft cpl.	-	1			Cylinder base gasket		
	4081	Kurbelwelle im Austausch	1	-			Cylinder base gasket		
	4083	Crankshaft in exchange	-	1			Cylinder base gasket		
45	4086	Flueßreparatursatz	1	-			Cylinder base gasket		
	4088	Connecting rod repair kit	-	1			Cylinder base gasket		
	424	Flueßreparatursatz	nB	nB			Cylinder base gasket		
	424	Needle bearing	nB	nB			Cylinder base gasket		
	424	Needle bearing	nB	nB			Cylinder base gasket		
	424	Needle bearing	nB	nB			Cylinder base gasket		
47	3795	Zylinderrollenlager NU 205 C 3	2	1			Cylinder base gasket		
		Cylinder roller bearing					Cylinder base gasket		
48	426	Zylinderrollenlager NU 305 C 3	-	1			Cylinder base gasket		
		Cylinder roller bearing					Cylinder base gasket		
49	8057	Wellendichtring 25 x 42 x 9	1	-			Cylinder base gasket		
	3469	Radial sealing ring	-	1			Cylinder base gasket		
		Wellendichtring 25 x 52 x 9/01	-	1			Cylinder base gasket		



Bild Nr.	EDV Nr.	Bezeichnung Description	Typ 361 MC 250	Typ 362 MC 490	Typ 361 MC 250	Typ 362 MC 490
77	1510	Federring B 6 DIN 128	6	6		
78	2967	Spring ring Stiftschraube	6	5		
79	1734	Stud Scheibe B 8,4 DIN 125	10	5		
80	1670	Washer Sechskantmutter M 8 DIN 934	10	5		
81	1735	Hexagon screw Soehelbe B 10,5 DIN 125	-	4		
82	1674	Washer Sechskantmutter M 10 DIN 934	-	4		
83	7470	Hexagon nut Ansaugstutzen	1	-		
7467		Intake flange Ansaugstutzen	-	1		
84	6810	Intake flange Intake flange	2	2		
85	603	Intake flange Zunderkerze	1	1		
86	8273	Spark plug Kupplungskorb vollst.	1	-		
87	8274	Clutch housing opl. Kupplungskorb	1	-		
88	1416	Clutch housing Senkriet 6 x 22 DIN 661	6	-		
89	8275	Counter sunk rivet Kupplungsabrad	1	-		
90	8101	Clutch pinion Kupplungskorb vollst.	-	1		
91	8096	Clutch housing opl. Kupplungskorb	-	1		
92	8102	Dämpferelement Rubber cushion	-	6		
93	8094	Kupplungsabrad Kupplungsabrad	-	1		
94	8077	Abdeckblech Clutch pinion	-	1		
95	1420	Cover plate Senkriet 6 x 30 DIN 661	-	6		
96	8276	Innenring Counter sunk rivet	1	1		
97	736	Inner ring Needle crane	2	2		
98	8277	Needle cage Distanzscheibe	2	2		
99	8100	Spacer bush Lamellenkörper	1	1		
100	8082	Clutch body Außenlamelle	6	6		
101	8083	Outer disc Innenlamelle	5	5		
102	8084	Innenlamelle Druckplatte	1	1		
103	8105	Druckplatte Druckschraube	5	5		
105	8106	Druckschraube Pressure bolt	5	-		
8071		Feder Spring	-	5		
106	8278	Sechskantmutter BM 16 x 1 DIN 439 Hexagon nut	1	1		
107	8091	Nadelrolle Needle roller			1	1
108	8087	Kugellager Ball bearing			1	1
109	8089	Druckstange Pressure rod			3	3
110	8072	Scheibe Ø 18 Washer			1	1
111	8092	Sicherungsscheibe Securing washer			1	1
112	8279	Kupplungshebel Clutch lever			1	1
113	8283	Kupplungs-Rückholfeder Clutch return spring			1	1
114	8228	Getriebehauptwelle C 15 Z Main shaft			1	-
115	8306	Getriebehauptwelle F 15 Z Main shaft			-	1
116	8229	Rad 2. Gang auf HW C 18 Z 2nd gear on mainshaft			1	-
117	8307	Rad 2. Gang auf HW F 18 Z 2nd gear on mainshaft			-	1
118	8230	Rad 3. Gang auf HW OD 21 Z 3rd gear on mainshaft			1	-
119	8340	Rad 3. Gang auf HW FL 1 - 21 Z 3rd gear on mainshaft			-	nB
		Rad 3. Gang auf HW FK 21 Z 3rd gear on mainshaft			-	nB
120	8231	Rad 4. Gang auf HW OD 23 Z 4th gear on mainshaft			1	-
121	8452	Rad 4. Gang auf HW FK 23 Z 4th gear on mainshaft			-	nB
		Rad 4. Gang auf HW FL 24 Z 4th gear on mainshaft			-	nB
122	8232	Rad 5. Gang auf HW C 1 - 25 Z 5th gear on mainshaft			1	-
123	8233	Sprengring SW 21 Circlip			4	-
124	8234	Anlaufscheibe Washer			2	-
125	8235	Sicherungsring A 21 x 1,2 DIN 471 Securing ring			2	2
126	8253	Paßscheibe PS 18 x 25 x 1 DIN 988 Washer			1	-
127	8237	Abtriebswelle Output shaft			1	-
128	8315	Abtriebswelle Output shaft			-	1
129	8238	Rad 1. Gang auf AW C 31 Z 1st gear on output shaft			1	-
130	8316	Rad 1. Gang auf AW F 31 Z 1st gear on output shaft			-	1
131	8239	Rad 2. Gang auf AW CD 29 Z 2nd gear on output shaft			1	-
132	8317	Rad 2. Gang auf AW F 28 Z 2nd gear on output shaft			-	1
133	8240	Rad 3. Gang auf AW C 26 Z 3rd gear on output shaft			1	-
134	8329	Rad 3. Gang auf AW FL 1 - 25 Z 3rd gear on output shaft			-	nB
		Rad 3. Gang auf AW FK 26 Z 3rd gear on output shaft			-	nB
135	8241	Rad 4. Gang auf AW OD 24 Z 4th gear on output shaft			1	-